



KONICA MINOLTA

**I WANT OFFICE  
SOLUTIONS  
THAT HELP ME  
ON MY WAY**



**INTELLIGENT  
OFFICE SOLUTIONS**

Giving Shape to Ideas



# WORKING ENVIRONMENTS IN STEP WITH TODAY'S WORLD

The modern working environment is a flood of data and information. Unless you're flexible, mobile and plugged into the Net around the clock, you're at a clear disadvantage. With Konica Minolta you can have the information at your fingertips wherever and whenever you need it.

Our solutions enhance and accelerate your business activities rather than slowing them down. It's the only way to stay ahead of your competitors and serve your customers competently. So with this in mind, we'd like to wish you an enjoyable and fruitful working day!



KONICA MINOLTA

# bizhub 654e

Black & white A3 multifunctional

Up to 65 pages per minute

## Functionality



– Black & white

Copying



– Black & white  
– PCL/PS  
– Local/Network  
– USB

Printing



– Colour  
– Black & white  
– Scan-to-eMail  
– Scan-to-Me  
– Scan-to-SMB  
– Scan-to-Home  
– Scan-to-FTP  
– Scan-to-Box  
– Scan-to-USB  
– Scan-to-WebDAV  
– Scan-to-DPWS  
– TWAIN Network

Scanning



– Super G3 Fax  
– PC-Fax  
– i-Fax  
– IP-Fax

Faxing



– Reprint  
– Distribution  
– Sharing  
– Box-to-Box  
– Box-to-USB

Box



Giving Shape to Ideas

## Technology

Emperon™ – print controller	Easily compatible with different users and IT environments through Konica Minolta's unified print technology	✓
Simitri® HD – polymerised toner	Delivers high print quality and yet ensures reduced print spending as well as lower environmental impact	✓
OpenAPI – solution platform	Server-based applications provide efficient workflows for the entire MFP fleet	✓
i-Option – special feature	Offers extended scope and advanced MFP functionality in line with individual requirements	✓
CSRC – remote service	Keeps productivity up with online monitoring of devices and consumables through the Konica Minolta service	✓
IWS – panel customisation	Improved user-device interaction and enhanced productivity through full MFP panel customisation	✓

## Option diagram

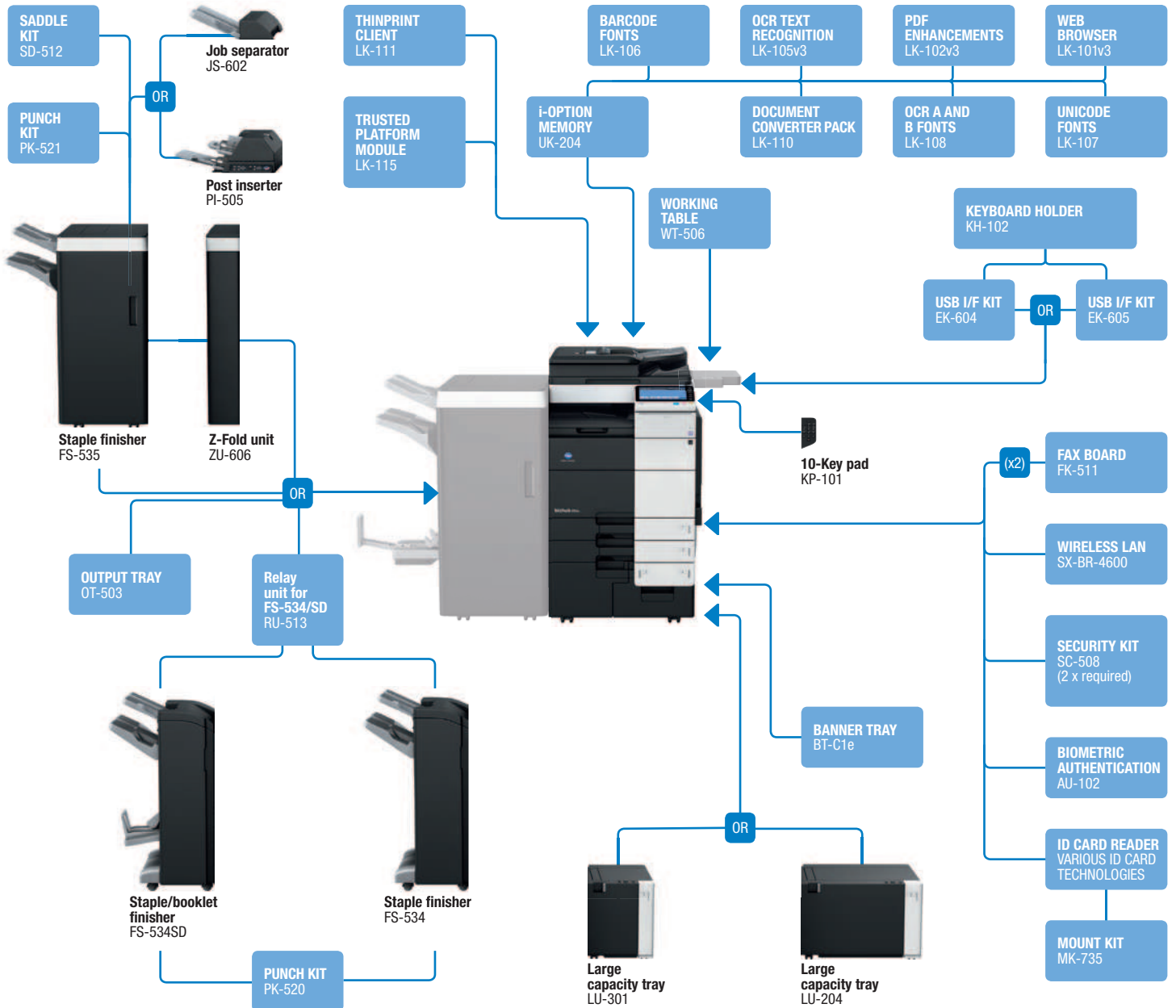

## Finishing functionalities

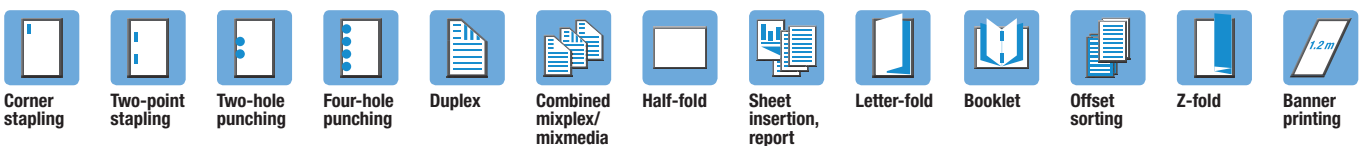

## Descriptions

<b>bizhub 654e</b>	Communication centre with 65 ppm b/w. Standard Emperon™ print controller with PCL 6, PCL 5, PostScript 3, PDF 1.7, XPS and OOXML support. Paper capacity of 500 + 500 + 1000 + 1500 sheets and 150-sheet manual bypass. Media from A6 to SRA3, 1.2 m banner and 52–300 gsm. 2 GB memory, 250 GB hard disk and Gigabit Ethernet standard.
<b>LU-204 Large capacity tray</b>	A4–SRA3, 2,500 sheets, 52–256 gsm
<b>LU-301 Large capacity tray</b>	A4, 3,000 sheets, 52–256 gsm
<b>FS-534 Staple finisher</b>	50-sheet stapling, 3,200 sheets max. output
<b>FS-534SD Booklet finisher</b>	50-sheets staple finisher, 20-sheets booklet finisher, 2,200 sheets max. output
<b>RU-513 Relay unit for FS-534/SD</b>	For FS-534/SD installation
<b>PK-520 Punch kit for FS-534/SD</b>	2/4 hole punching, autoswitching
<b>FS-535 Staple finisher</b>	100 sheets stapling, 3,200 sheets max. output
<b>PK-521 Punch kit for FS-535</b>	2/4 hole punching, autoswitching
<b>SD-512 Saddle kit for FS-535</b>	Booklet finishing, half-fold, letter-fold
<b>PI-505 Post inserter for FS-535</b>	Cover insertion, post finishing
<b>JS-602 Job separator for FS-535</b>	Separation of fax output, etc.
<b>ZU-606 Z-fold unit for FS-535</b>	Z-fold for A3 prints, 2/4 hole punching
<b>OT-503 Output tray</b>	Output tray used instead of finisher
<b>KP-101 10-Key pad</b>	For use instead of touchscreen

<b>WT-506 Working table</b>	Authentication device placement
<b>FK-511 Fax board</b>	Super G3 fax, digital fax functionality
<b>KH-102 Keyboard holder</b>	To place USB keyboard
<b>EK-604 USB I/F kit</b>	USB keyboard connection
<b>EK-605 USB I/F kit</b>	USB keyboard connection, Bluetooth
<b>ID card reader</b>	Various ID card technologies
<b>MK-735 Mount kit</b>	Installation kit for ID card reader
<b>AU-102 Biometric authentication</b>	Finger vein scanner
<b>SC-508 Security kit</b>	Copy guard function
<b>BT-C1e Banner tray</b>	Multi-page banner feeding
<b>LK-101v3 Web browser</b>	Web browser and IWS
<b>LK-102v3 PDF enhancements</b>	PDF/A, PDF encryption, digital signature
<b>LK-105v3 OCR text recognition</b>	Searchable PDF and PPTX
<b>LK-106 Barcode fonts</b>	Supports native barcode printing
<b>LK-107 Unicode fonts</b>	Supports native Unicode printing
<b>LK-108 OCR A and B fonts</b>	Supports native OCR A and B font printing
<b>LK-110 Document converter pack</b>	Generates various file formats incl. DOCX, XLSX and PDF/A
<b>LK-111 ThinPrint® Client</b>	Print data compression for reduced network impact
<b>LK-115 TPM activation</b>	Trusted Platform Module for protection of data encryption and decryption
<b>UK-204 i-Option memory</b>	Memory extension for i-Options
<b>SX-BR-4600 Wireless LAN</b>	Wireless LAN to network connector

## Technical specifications

### SYSTEM SPECIFICATIONS

<b>System memory</b>	2,048 MB
<b>System hard disk</b>	250 GB
<b>Interface</b>	10-Base-T/100-Base-T/1,000-Base-T Ethernet; USB 2.0 Wi-Fi 802.11b/g (optional)
<b>Network protocols</b>	TCP/IP (IPv4 / IPv6); IPX/SPX; NetBEUI; AppleTalk (EtherTalk); SMB; LPD; IPP; SNMP; HTTP
<b>Frame types</b>	Ethernet 802.2; Ethernet 802.3; Ethernet II; Ethernet SNAP
<b>Automatic document feeder</b>	Up to 150 originals; A6–A3; 35–210 gsm Dualscan ADF
<b>Printable paper size</b>	A6–SRA3, customised paper sizes; banner paper max. 1,200 x 297 mm
<b>Printable paper weight</b>	52–300 gsm
<b>Paper input capacity</b>	Standard: 3,650 sheets Max.: 6,650 sheets
<b>Tray 1</b>	500 sheets, A5–SRA3, 52–256 gsm
<b>Tray 2</b>	500 sheets, A5–SRA3, 52–256 gsm
<b>Tray 3</b>	1,500 sheets, A4, 52–256 gsm
<b>Tray 4</b>	1,000 sheets, A4, 52–256 gsm
<b>Large capacity tray LU-301 (optional)</b>	3,000 sheets, A4, 52–256 gsm
<b>Large capacity tray LU-204 (optional)</b>	2,500 sheets, A4–SRA3, 52–256 gsm
<b>Manual bypass</b>	150 sheets, A6–SRA3, custom sizes, banner, 52–300 gsm
<b>Automatic duplexing</b>	A5–SRA3; 52–256 gsm
<b>Finishing modes (optional)</b>	Offset; group; sort; staple; punch; post insertion; z-fold; centre-fold; letter fold; booklet
<b>Output capacity (with finisher)</b>	Max.: 3,300 sheets
<b>Output capacity (without finisher)</b>	Max.: 250 sheets
<b>Stapling</b>	Max.: 100 sheets or 94 sheets + 2 cover sheets (up to 209 gsm)
<b>Stapling output capacity</b>	Max.: 1,000 sheets
<b>Letter fold</b>	Up to 3 sheets
<b>Letter fold capacity</b>	Max.: 30 sheets (tray); unlimited
<b>Booklet</b>	Max.: 20 sheets or 19 sheets + 1 cover sheet (up to 209 gsm)
<b>Booklet output capacity</b>	Max.: 100 sheets (tray); unlimited
<b>Copy/print volume (monthly)</b>	Rec.: 80,000 pages; Max.: 187,000 pages
<b>Toner lifetime</b>	48,960 pages

<b>Imaging unit lifetime</b>	300,000 pages/1,200,000 pages (Drum/Developer)
<b>Power consumption</b>	220–240 V / 50/60 Hz Less than 2.1 kW (system)
<b>System dimensions (W x D x H)</b>	650 x 799 x 1,155 mm
<b>System weight</b>	Approx. 201 kg

### COPIER SPECIFICATIONS

<b>Copying process</b>	Electrostatic laser copy, tandem, indirect
<b>Toner system</b>	Simitri® HD polymerised toner
<b>Copy/print speed A4</b>	Up to 65 ppm
<b>Copy/print speed A3</b>	Up to 33 ppm
<b>Autoduplex speed A4</b>	Up to 65 ppm
<b>1st copy out time</b>	3.7 sec.
<b>Warm-up time</b>	Approx. 22 sec. <sup>2</sup>
<b>Copy resolution</b>	600 x 600 dpi
<b>Gradation</b>	256 gradations
<b>Multicopy</b>	1–9,999
<b>Original format</b>	A5–A3
<b>Magnification</b>	25–400% in 0.1% steps; auto-zooming
<b>Copy functions</b>	Chapter; cover and page insertion; proof copy (print and screen); adjustment test print; digital art functions; job setting memory; poster mode; image repeat; overlay (optional); stamping; copy protection

<sup>1</sup> If the maximum volume is reached within a period of one year, then a maintenance cycle must be performed

<sup>2</sup> Warm-up time may vary depending on the operating environment and usage

**PRINTER SPECIFICATIONS**

<b>Print resolution</b>	1,800 x 600 dpi; 1,200 x 1,200 dpi
<b>Page description language</b>	PCL6 (XL 3.0); PCL 5; PostScript 3 (CPSI 3016); XPS
<b>Operating systems</b>	Windows VISTA (32/64) Windows 7 (32/64) Windows 8 (32/64) Windows 10 (32/64) Windows Server 2008 (32/64) Windows Server 2008 R2 Windows Server 2012 Windows Server 2012 R2 Macintosh OS X 10.x Unix, Linux, Citrix
<b>Printer fonts</b>	80 PCL Latin; 137 PostScript 3 Emulation Latin
<b>Print functions</b>	Direct print of PCL, PS, TIFF, XPS, PDF (v1.7), encrypted PDF files and OOXML (DOCX, XLSX, PPTX); mixmedia and mixplex; "Easy Set" job programming; overlay; watermark; copy protection; carbon copy print
<b>Mobile Printing</b>	AirPrint (iOS), Mopria (Android), Google Cloud Print (optional), Konica Minolta Print Service (Android), PageScope Mobile (iOS & Android)

**SCANNER SPECIFICATIONS**

<b>Scan speed (mono/colour)</b>	Up to 180 ipm
<b>Scan resolution</b>	Max.: 600 x 600 dpi
<b>Scan modes</b>	Scan-to-eMail (Scan-to-Me) Scan-to-SMB (Scan-to-Home) Scan-to-FTP Scan-to-Box Scan-to-USB Scan-to-WebDAV Scan-to-DPWS Network TWAIN scan
<b>File formats</b>	JPEG; TIFF; PDF; PDF/A 1a and 1b (optional); Compact PDF; encrypted PDF; searchable PDF (optional); XPS; compact XPS; PPTX and searchable PPTX (optional); searchable DOCX/ XLSX (optional)
<b>Scan destinations</b>	2,100 (single + group); LDAP support
<b>Scan functions</b>	Annotation (text/time/date) for PDF; up to 400 job programs; realtime scan preview

**FAX SPECIFICATIONS**

<b>Fax standard</b>	Super G3 (optional)
<b>Fax transmission</b>	Analogue i-Fax Colour i-Fax (RFC3949-C) IP-Fax
<b>Fax resolution</b>	Max.: 600 x 600 dpi (ultra-fine)
<b>Fax compression</b>	MH; MR; MMR; JBIG
<b>Fax modem</b>	Up to 33.6 Kbps
<b>Fax destinations</b>	2,100 (single + group)
<b>Fax functions</b>	Polling; time shift; PC-Fax; receipt to confidential box; Receipt to e-mail/FTP/SMB; up to 400 job programs

**USER BOX SPECIFICATIONS**

<b>Max. storable documents</b>	Up to 3,000 documents or 10,000 pages
<b>Type of user boxes</b>	Public Personal (with password or authentication) Group (with authentication)
<b>Type of system boxes</b>	Secure print Encrypted PDF print Fax receipt Fax polling
<b>User box functionality</b>	Reprint; combination Download Sending (e-mail/FTP/SMB and fax) Copy box to box

**SYSTEM FEATURES**

<b>Security</b>	ISO15408/IEEE 2600.1 (in evaluation); IP filtering and port blocking; SSL2; SSL3 and TLS1.0 network communication; IPsec support; IEEE 802.1x support; user authentication; Authentication log; secure print; Hard disk overwrite (8 standard types); Hard disk data encryption (AES 256); Memory data auto deletion; Confidential fax receipt; Print user data encryption; copy protection (Copy Guard, Password Copy) optional
<b>Accounting</b>	Up to 1,000 user accounts; Active Directory support (user name + password + e-mail + smb folder) User function access definition Biometric authentication (finger vein scanner) optional ID card authentication (ID card reader) optional"
<b>Software</b>	PageScope Net Care Device Manager PageScope Data Administrator PageScope Box Operator PageScope Direct Print Print Status Notifier Driver Packaging Utility Log Management Utility

- All specifications refer to A4-size paper of 80 gsm quality.
- The support and availability of the listed specifications and functionalities varies depending on operating systems, applications and network protocols as well as network and system configurations.
- The stated life expectancy of each consumable is based on specific operating conditions such as page coverage for a particular page size (5% coverage of A4). The actual life of each consumable will vary depending on use and other printing variables including page coverage, page size, media type, continuous or intermittent printing, ambient temperature and humidity.
- Some of the product illustrations contain optional accessories.
- Specifications and accessories are based on the information available at the time of printing and are subject to change without notice.
- Konica Minolta does not warrant that any specifications mentioned will be error-free.
- All brand and product names may be registered trademarks or trademarks of their respective holders and are hereby acknowledged.



Visit our product page

# YOUR EMPLOYEES' POTENTIAL: WE'LL HELP YOU USE IT TO THE FULL!

With office solutions from Konica Minolta, you and your employees can really get ahead. This is so because our solutions are geared to your requirements, not the other way round. We focus on achieving a perfect symbiosis of the paper and digital worlds. After all, it is the entire document life cycle that counts.

## ▀ The complete document life cycle

Printing is only one part of the document life cycle. We know there's more to it than that (such as creation, archiving and retrieval). Information is a valuable "resource", but you can only use it to the full if you view the document life cycle as a whole.

## ▀ Intelligent document creation

Scan in paper documents, perform text recognition and output forms and barcodes – these functions provide the perfect basis for automatic forwarding, editing and archiving.

## ▀ Edit paper documents in Word and Excel

To edit paper-based documents electronically, simply scan in your paper documents and you're ready to go. It's as easy as that! Time-consuming transcription work immediately becomes a thing of the past.

## ▀ Easy archiving solutions

Easy and efficient archiving solutions based on searchable PDF files enable you to locate archived documents quickly.

### ▀ Good to know!

Statistically speaking, each employee spends an average of 7.4 hours a week searching for data. It doesn't have to be that way!

(IDC 2010)



## ▀ Greater effectiveness on the move: mobile printing from smartphones and tablets

Now you can print from mobile devices and take advantage of mobile data entry whenever and wherever you want, thanks to Wi-Fi, e-mail and AirPrint.

## ▀ Manage documents efficiently

We can offer two options: 1) Solutions to scan your documents directly into your existing document management system or 2) a completely new DMS, which we will develop and implement for you. Your needs come first.

## ▀ Follow-me printing

Want to be able to send your print job and collect the document from any device on the network? With follow-me printing, you can. That's just one example of the many ways we can facilitate mobile working.

# THE BEST OF BOTH WORLDS: DIGITAL AND PAPER-BASED

Multifunctional systems and applications from Konica Minolta bring together the digital and paper-based worlds. As a result, they can accommodate all the demands of modern business with smooth workflows that save you time and money.

## Print and copy with absolute ease

Not only do our multifunctional systems allow no-nonsense printing and copying, they're also brilliant at handling all kinds of media: formats ranging from A6 to SRA3, grammages from 52 to 300 gsm, plus user-defined formats and banners up to a striking 1.2 m in length.

## Highly efficient scanning and faxing

Quick and easy scanning has become an indispensable part of everyday office life. Once digitalised, documents can be directly transferred to an electronic mailbox, an archive, a USB stick or an FTP server. Faxes can also be sent or received directly via a PC.

## Open your eyes to perfect print quality

You can enjoy high-quality printouts thanks to our high-definition polymerised toner (Simitri® HD). At the same time your electricity bill is significantly reduced due to a lower melting temperature and power consumption.

## All's well that ends well with a professional finish

We offer a wide range of professional finishing functions, the likes of which you won't find anywhere else: from stapling and folding right through to brochures that are ready to go. A practical solution for handouts, direct mailings or customer leaflets.

## Easy and customised operation.

- Large colour touch screen
- Works like a smartphone
- Fully functional Web browser
- Customisation service: have the design and menu structure customised for your organisation



Our bizhub multifunctionals were named the product line of the year in 2011, 2012 and 2013.





# OFFICE SOLUTIONS THAT THE IT DEPARTMENT WILL LIKE

Printing and document solutions from Konica Minolta are not just easy to implement – once up and running, they require very little maintenance. If you want, we even take full charge of both aspects with our professional services. This frees up time for IT departments to spend on their core competencies, thus benefitting the whole company.

## “Downtime”: a little word you need not worry about

Konica Minolta systems are robust and have been designed with reliable long-term operation in mind. In the unlikely event of faults, help is at hand in the form of interactive tutorials on the device display, a remote diagnostics system and a fast-response service team.

## Easy automation: toner orders and service requests

Can't print because no one has ordered any toner or placed a service request? Put a stop to this problem with Konica Minolta automated services and let your device take charge!

## Device data and printing costs at a glance

From current running data and toner levels right through to precise printing costs and error messages, the device overview shows you everything at a glance – at any time and at the touch of a button.

## The universal printer driver

One for all: the universal printer driver is available for most Konica Minolta devices, enabling employees to operate different printing systems with ease.

## Let us worry about your printing infrastructure

Konica Minolta has developed a professional approach for finding and implementing the right printer landscape for you. These Optimized Print Services (OPS) also include a long-term management service. All you have to worry about is your core business, saving you time and money as well as your sanity.

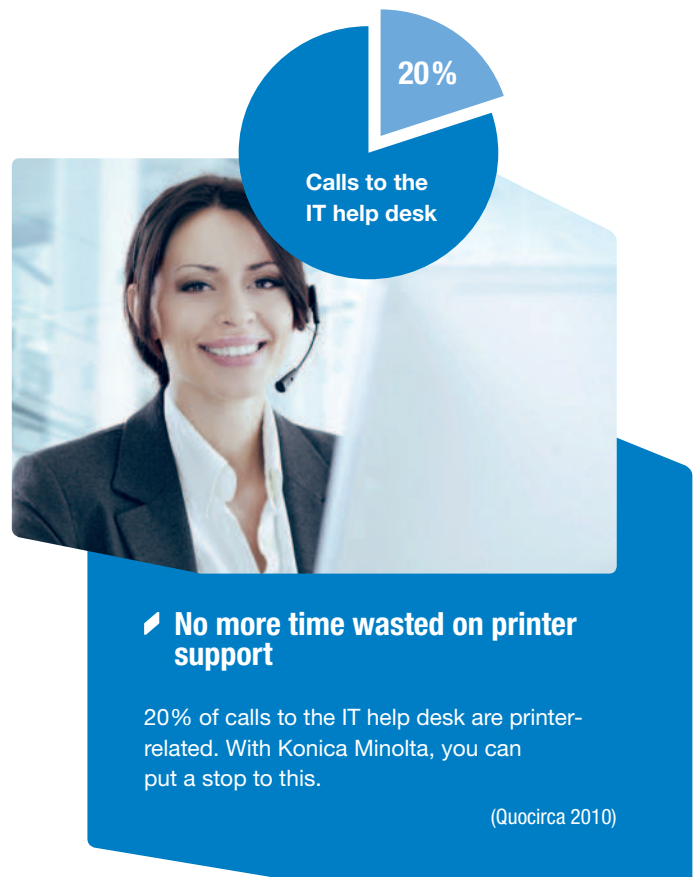

## Smart device management

So practical! You no longer have to assign user rights or carry out firmware updates separately on each device. With Konica Minolta, you can do it all with one central tool.

## Complete integration

Whether in a Windows, Linux or Mac environment, you'll have absolutely no problems integrating bizhub systems and various software solutions, which are easy to connect to SAP and SharePoint, etc.

# CUT DOCUMENT COSTS AND INCREASE EFFICIENCY

Are you aware of your printing costs? And did you know that the purchase of hardware and toner only accounts for a small proportion? With the right partner, you can not only calculate the overall costs precisely (including administration, financing, logistics, etc.) but also save a great deal. Konica Minolta has a lot to offer here:

## ▀ The first step: cost transparency

Don't just record your printing costs in general but allocate them to users, departments and projects. This is the key to performing precise analyses and making your employees more cost-conscious.

### ▀ Are you aware of your document costs?



From our experience we know that only 1 in 10 organisations know what they spend on printing.



On average, up to 6% of a company's revenue is spent on document management. (InfoTrends 2010)

40% of printouts are discarded within 24 hours. (Newsweek 2009)

For every euro spent on printing as such, another nine euros are spent on burdened costs. (ALL Associates Group 2012)



**Printing costs**  
(Hardware, toner, maintenance, paper, etc.)

**Burdened costs**  
(IT support, administration, purchasing & storage of materials, document-related processes, etc.)

### ▀ The good news:



You could save up to 30% of these costs. (IDC 2009, Gartner 2013)

## ▀ Cost savings: optimise your printer fleet

Your printer fleet can easily become a money trap. Not using it to full capacity is just as expensive as a high error rate. With our effective monitoring tools, you keep your printer fleet under control and spot potential savings immediately.

## ▀ Digitisation saves time and money

The digital world provides rapid access to information, thereby increasing productivity while frequently reducing the amount of material that has to be printed. What's more, an electronic archive can free up valuable office space. The result: you save time and money.

## ▀ Easy print cost control

Printing costs can actually be controlled: define, for example, who is allowed to print in colour. You can stipulate that only efficient systems are to be used for large print jobs. Or make duplex printing the default setting. The world's your oyster!

## ▀ Less is more: avoid unnecessary prints

It may be hard to believe, but one in nine printouts never even gets collected from the printer. It doesn't have to be that way! With follow-me printing, the printing process has to be enabled directly on the device.

## ▀ Even more efficient: smooth document workflows

With Optimized Print Services (OPS) by Konica Minolta, all of your business-relevant document processes are thoroughly analysed in order to design and implement improved workflows. You benefit from savings in time and money and thus ensure the highest possible efficiency in your daily business.



# COMPLETE PEACE OF MIND: SECURITY COMES FIRST

In a world where the information advantage is of ever increasing importance, data security is also growing in significance – that goes for paper-based and digital data alike. For your peace of mind, Konica Minolta is an industry leader in terms of its security standards.

## Secure integration into your network

The printers on your network must also meet all the necessary safety requirements. Our IEEE 802.1X SSL and IPsec protocol authentication methods allow easy integration into protected networks, plus secure network communication. Virtually all bizhub systems conform to the ISO 15408 EAL3 standard, which means they meet the highest international security standards.

## Protection of confidential documents

When it comes to protecting confidential documents, there's no room for compromise, whether they are on the printer hard disk or in the collection tray. With Konica Minolta, protection is ensured in various ways, including data encryption, secure deletion, watermark copy protection and PDF signatures.

## Access control and user rights

User authentication is one of the key factors for ensuring security. With us, it comes in the form of a magnetic card, a PIN code or a biometric fingerprint scan. Individual access rights can be defined for each user.



## Your confidential data is safe

- The printing of confidential data (e.g. payslips, R&D results) or personal documents is protected
- Data security is always essential when employees leave and new ones join; additionally, protection against industrial espionage is becoming increasingly important
- Electronic archives can be protected against conventional burglaries or accidental fire

## Environmental well-being

Konica Minolta puts environmental friendliness and sustainability at the top of the agenda. This is why both our solutions and our organisation have been given numerous awards.



## Better safe than sorry: secure print

To prevent any printouts from falling into the wrong hands, the "Secure print" feature requires authentication directly on the device prior to printing. This is very useful when handling sensitive information within personnel departments, for example.

1. Send a print job.
2. Enter the code on any device.
3. Start printing.



KONICA MINOLTA

# OUR SOLUTIONS SPEAK FOR US SO DO OUR CUSTOMERS!

“The reduction and modernisation of our printer fleet has led to significant cost savings. We are now working with modern machines, connected solutions and services that guarantee safe and uninterrupted operation of the entire output infrastructure. Thanks to Konica Minolta’s support, my IT group has to do less maintenance work on office devices, and our colleagues working with the new machines benefit from new functions that make their everyday work easier.”

Peter Toth, Head of IT at ORFK DA GEI

“The cooperation with Konica Minolta was at a very high level. The company arranged a really smooth transition from the old fleet to a new one with printing devices from Konica Minolta. The required efficiency and reliability was fully reached. For us, Konica Minolta has become a reliable partner not only for a managed printing environment, but also as a provider of high-quality and efficient software solutions such as PageScope Enterprise Suite.”

Mr Vojta from AHOLD Czech Republic, a.s.

Your Konica Minolta Business Solutions Partner:

**Konica Minolta**  
**Business Solutions Europe GmbH**  
Europaallee 17  
30855 Langenhagen  Germany  
Tel.: +49 (0) 511 74 04-0  
Fax: +49 (0) 511 74 10 50  
[www.konicaminolta.eu](http://www.konicaminolta.eu)